



**Power Transmission**

## **Product-Range Automotive Belts**



**optibelt MARATHON 1** Fan Belts –  
raw edge, moulded cogged, maintenance free

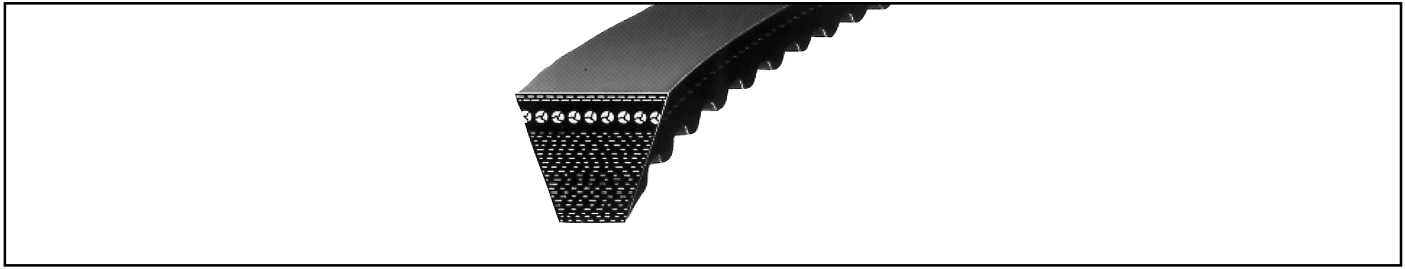

Section AVX 10						Section AVX 13					
Euro/ each	outside lgth. (mm)	£/ each	Euro/ each	outside lgth. (mm)	£/ each	Euro/ each	outside lgth. (mm)	£/ each	Euro/ each	outside lgth. (mm)	£/ each
BM = 10 pieces						BM = 10 pieces					
	600			975			725			1500	
	613			980			750			1525	
	617			990			775			1550	
	625			995			800			1575	
	630			1000			810			1600	
	635			1005			818			1625	
	643			1013			825			1650	
	650			1025			835			1675	
	660			1050			850			1700	
	675			1060			875			1725	
	685			1070			900			1750	
	690			1075			918			1775	
	695			1080			925			1800	
	700			1085			950			1900	
	710			1090			960			1950	
	715			1100			975			2000	
	725			1110			985			2025	
	730			1125			992			2500	
	735			1140			1000				
	740			1150			1015				
	750			1165			1025				
	763			1175			1030				
	775			1184			1040				
	785			1200			1050				
	800			1215			1055				
	813			1225			1060				
	818			1235			1075				
	825			1250			1100				
	838			1275			1125				
	844			1300			1145				
	850			1325			1150				
	864			1340			1175				
	875			1350			1200				
	888			1375			1225				
	900			1400			1250				
	913			1425			1275				
	920			1450			1285				
	925			1475			1300				
	930			1500			1325				
	935			1525			1350				
	940			1550			1375				
	950			1575			1400				
	960			1600			1425				
	965			1625			1450				
	970						1475				
Weight: ≈ 0,076 kg/m						Weight: ≈ 0,118 kg/m					

BM = Bundle quantity

Other sizes available on request.

Sections AVX 10 and AVX 13 are manufactured in accordance with BS AU 150b, DIN 7753 part 3 and ISO 2790 standards.

**All deliveries are subject to our "General Conditions of Sale"**

**Prices**

The prices in this list are the purchase prices for Automotive Distributors. They are subject to prior sale and all taxes are applicable at date of invoice.

All other price lists to are superceded by the introduction of this list.

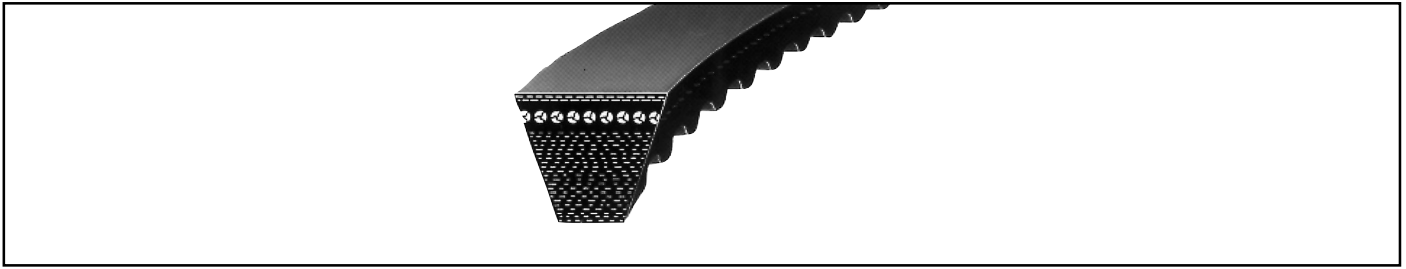

Section AVX 11,0			Section AVX 11,5			Section AVX 11,9		
Euro/ each	outside length (mm)	£/ each	Euro/ each	outside length (mm)	£/ each	Euro/ each	outside length (mm)	£/ each
BM = 10 pieces			BM = 10 pieces			BM = 10 pieces		
	528			685 695 730 755 790			650 670 675 690 710 758 768 772 783 793 806 864 876 885 903 950 965 982 1010 1036 1042 1150 1171 1183	
Weight: ≈ 0,089 kg/m								
Section AVX 11,2								
	BM = 10 each 785 820 866							
Weight: ≈ 0,089 kg/m			Weight: ≈ 0,093 kg/m			Weight: ≈ 0,098 kg/m		

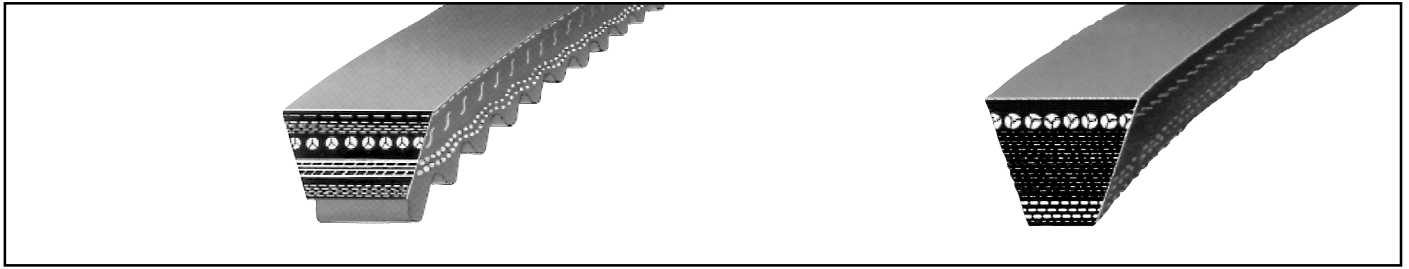

Section AVX 13					Section AVP 13			
Euro/ each	outside length (mm)	£/ each	Euro/ each	outside length (mm)	£/ each	Euro/ each	outside length (mm)	£/ each
BM = 10 pieces					BM = 10 pieces			
	750			1425			2018	
	775			1450			2025	
	800			1475			2050	
	813			1500			2100	
	825			1525			2250	
	850			1550			2350	
	865			1575			2375	
	875			1600			2400	
	900			1625			2425	
	925			1650			2450	
	950			1675			2500	
	975			1700			2550	
	1000			1725			2575	
	1025			1750				
	1050			1775				
	1060			1800				
	1075			1825				
	1100			1850				
	1125			1875				
	1150			1900				
	1175			1925				
	1200			1950				
	1225			1975				
	1250			2000				
	1275							
	1300							
	1325							
	1350							
	1375							
	1400							
Weight: ≈ 0,102 kg/m					Weight: ≈ 0,116 kg/m			

M=S stands for **M**atched **S**ets. Belts so marked are so close in length tolerance that they can be made into sets without additional measurement.

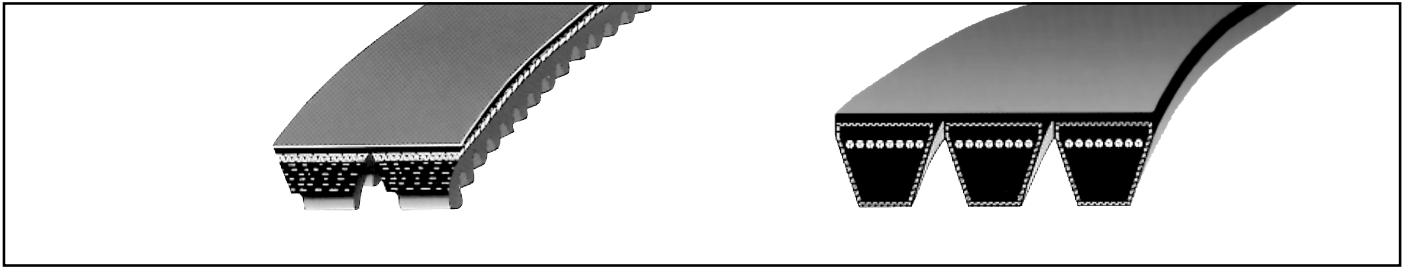

Section AVX 10 – 2 Ribs			Section AVX 13 – 2 Ribs			Section SPB – 2 Ribs			Section SPB – 3 Ribs		
Euro/ each	outside lgth. (mm)	£/ each	Euro/ each	outside lgth. (mm)	£/ each	Euro/ each	datum lgth. (mm)	£/ each	Euro/ each	datum lgth. (mm)	£/ each
	1375 1400 1450 1475 1500 1550 1575 1600 1675 1725			1150 1375 1450 1475 1500 1575 1625 1925 1950 2000 2025 2425			2055▪ 2100▪ 2280			2100▪	
Weight: ≈ 0,200 kg/m			Weight: ≈ 0,320 kg/m			Weight: ≈ 0,504 kg/m			Weight: ≈ 0,756 kg/m		

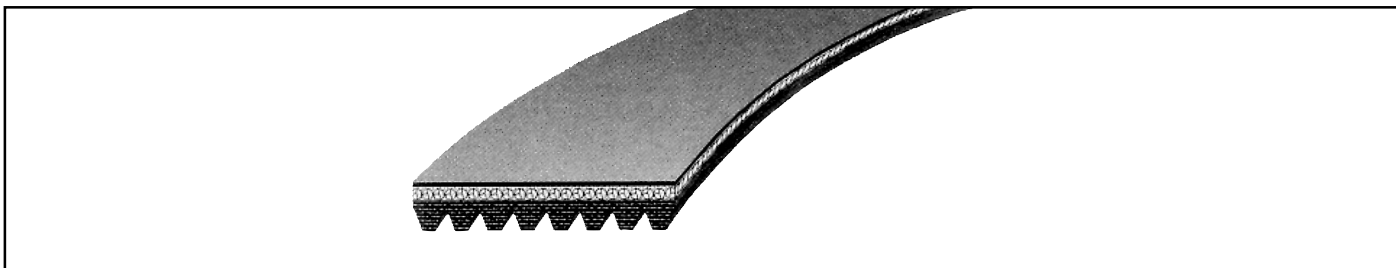

Section PK – 3 Ribs			Section PK – 4 Ribs					
Euro/ each	Effective length (mm)	£/ each	Euro/ each	Effective length (mm)	£/ each	Euro/ each	Effective length (mm)	£/ each
	550			560			1005	
	560			590			1010	
	600			605			1015	
	605			640			1020	
	625			648			1025	
	630			675			1030	
	648			685			1040	
	668			698			1045	
	675			705			1055	
	685			715			1060	
	690			725			1065	
	715			730			1080	
	720			735			1090	
	735			737			1100	
	750			755			1110	
	763			763			1120	
	780			775			1125	
	785			780			1145	
	790			790			1160	
	800			795			1165	
	805			800			1190	
	812			812			1205	
	815			815			1215	
	820			825			1230	
	825			830			1237	
	830			835			1245	
	850			841			1260	
	855			845			1265	
	884			850			1325	
	905			855			1415	
	913			858			1485	
	940			865			1510	
	950			870			1520	
	960			875				
	970			880				
	975			884				
	1000			890				
	1025			900				
	1080			905				
	1090			913				
	1150			920				
	1215			925				
	1285			935				
				940				
				945				
				950				
				954				
				962				
				966				
				970				
				975				
				985				
				990				
				995				
				1000				

Other sizes available on request.

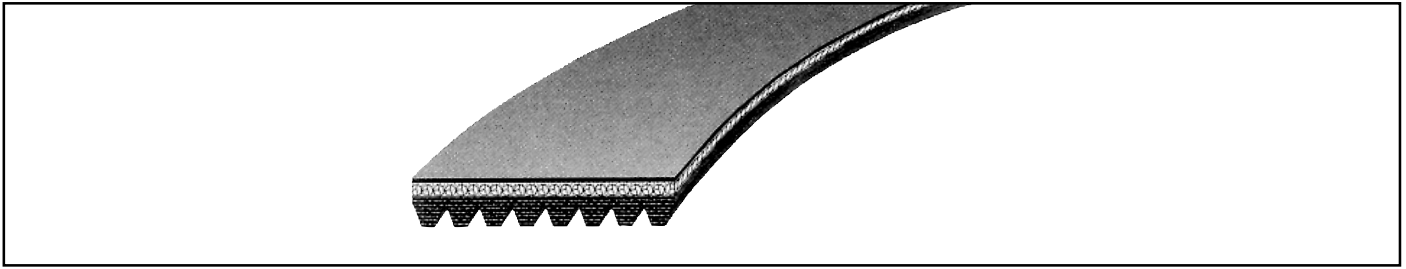

**Section PK – 5 Ribs**

<b>Euro/ each</b>	<b>Effective length (mm)</b>	<b>£/ each</b>	<b>Euro/ each</b>	<b>Effective length (mm)</b>	<b>£/ each</b>
	625			1110	
	630			1120	
	640			1125	
	675			1130	
	690			1135	
	698			1140	
	710			1155	
	715			1160	
	725			1165	
	735			1190	
	775			1200	
	790			1225	
	800			1240	
	812			1250	
	820			1270	
	825			1275	
	830			1290	
	835			1295	
	845			1300	
	850			1330	
	865			1345	
	870			1350	
	875			1385	
	880			1450	
	886			1460	
	890			1500	
	900			1590	
	905			1610	
	913			1790	
	920			1815	
	925			1885	
	930				
	935				
	940				
	950				
	954				
	962				
	970				
	975				
	985				
	990				
	1000				
	1005				
	1010				
	1015				
	1025				
	1030				
	1040				
	1055				
	1060				
	1065				
	1070				
	1080				
	1090				
	1100				

Other sizes available on request.

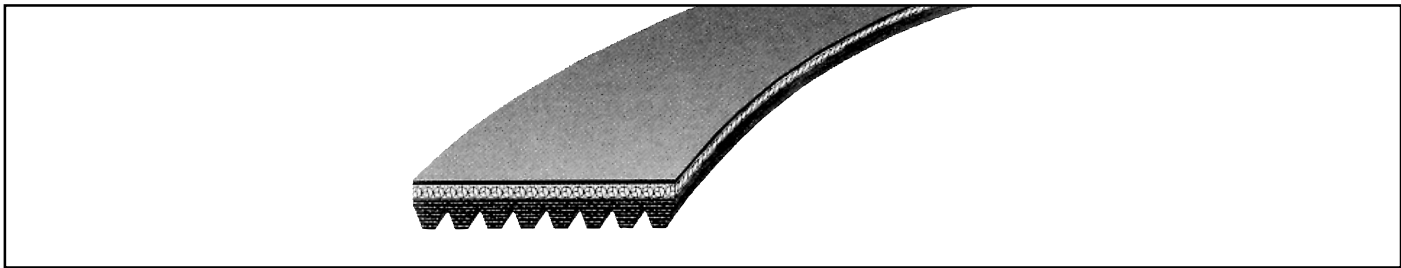

**Section PK – 6 Ribs**

Euro/ each	Effective length (mm)	£/ each	Euro/ each	Effective length (mm)	£/ each	Euro/ each	Effective length (mm)	£/ each
	675			1200			1980	
	698			1230			2000	
	720			1245			2020	
	725			1255			2030	
	730			1265			2040	
	737			1270			2050	
	750			1275			2055	
	825			1285			2080	
	845			1290			2100	
	850			1325			2115	
	858			1345			2120	
	865			1350			2140	
	870			1400			2145	
	875			1415			2155	
	884			1420			2170	
	890			1425			2176	
	894			1432			2200	
	900			1450			2205	
	906			1460			2215	
	913			1530			2230	
	920			1540			2240	
	925			1550			2255	
	935			1560			2260	
	950			1570			2270	
	962			1590			2280	
	975			1605			2285	
	985			1610			2300	
	995			1625			2315	
	1000			1635			2330	
	1005			1655			2355	
	1015			1660			2390	
	1020			1675			2415	
	1025			1685			2445	
	1040			1690			2460	
	1045			1705			2465	
	1055			1715			2490	
	1060			1720			2525	
	1065			1725			2535	
	1070			1735			2550	
	1075			1748			2680	
	1080			1755				
	1090			1760				
	1100			1775				
	1105			1795				
	1110			1815				
	1120			1820				
	1125			1840				
	1130			1850				
	1140			1865				
	1145			1885				
	1150			1900				
	1165			1905				
	1180			1920				
	1190			1928				
	1195			1965				

Other sizes available on request.



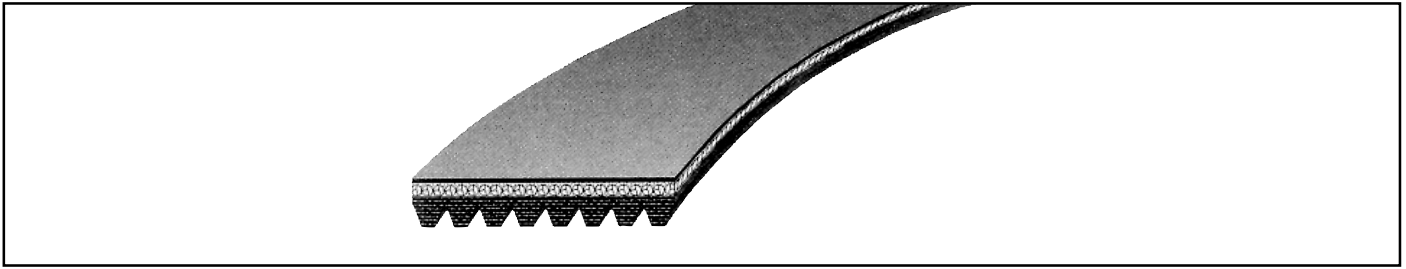

Section PK – 7 Ribs			Section PK – 8 Ribs			Section PK – 9 Ribs			Section PK – 10 Ribs		
Euro/ each	Effect. length (mm)	£/ each	Euro/ each	Effect. length (mm)	£/ each	Euro/ each	Effect. length (mm)	£/ each	Euro/ each	Effect. length (mm)	£/ each
	920 1110 1175 1215 1290 1570 1580 1605 1675 1715 1730 1950 1980			1400 2188 2337 2440 2465 2523 2585			1200 1290 2835 4100 4145			1215	
<b>Section DPK – 7 Ribs*</b>											
	1360										

Other sizes available on request. \* double sided ribbed belt.

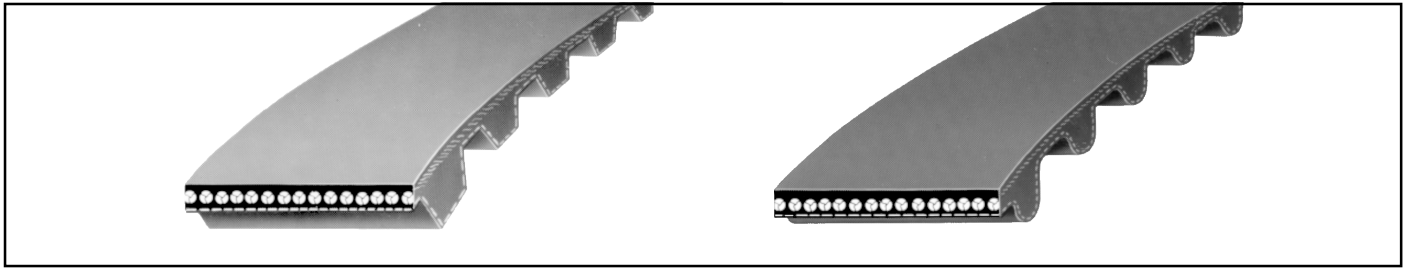

Euro/each	Size	£/each	Euro/each	Size	£/each
	35096 x 3/4"○ HR 39107 x 3/4"○ HR 39107 x 21,6 mm HR 39117 x 21 mm HR 39121 x 20 mm○			41094 x 3/4" 41095 x 3/4"* 41097 x 3/4" 41097 x 1" 41098 x 17 mm●	
	HR 39121 x 21,1 mm HR 39121 x 24 mm○ HR 39123 x 20 mm HR 39123 x 24 mm HR 39124 x 26 mm			41098 x 3/4"* 41098 x 1"○ 41099 x 15 mm○ 41100 x 17 mm● 41102 x 3/4"	
	HR 39145 x 21,6 mm HR 39159 x 1" HR 39169 x 1"○ HR 39177 x 25 mm HR 39178 x 1"			41102 x 20,5 mm 41103 x 3/4" 41104 x 15 mm* 41104 x 17 mm 41105 x 3/4"*●	
	40149 x 25 mm 40247 x 25 mm 40249 x 24 mm 40280 x 19 mm HR 40283 x 24 mm			41106 x 3/4" 41107 x 3/4" 41108 x 3/4" 41109 x 3/4" 41110 x 18 mm	
	40301 x 24 mm 40308 x 17 mm* 40353 x 24 mm 40390 x 23 mm 40427 x 17 mm			41111 x 3/4" 41111 x 1"○ 41112 x 3/4" 41113 x 3/4" 41115 x 3/4"	
	HR 40433 x 17 mm 40433 x 20 mm HR 40444 x 23 mm HR 40446 x 3/4" HR 40451 x 1"			41116 x 3/4"* 41117 x 15 mm 41118 x 15 mm 41118 x 3/4"* 41119 x 3/4"	
	HR 40452 x 23 mm HR 40455 x 23 mm HR-TP 40458 x 14 mm HR 40474 x 23 mm HR 40496 x 30 mm			41120 x 15 mm 41120 x 18 mm 41120 x 3/4"○ 41121 x 15 mm 41121 x 18 mm	
	HR 40802 x 20 mm HR 40812 x 20 mm HR 40815 x 24 mm 40819 x 24 mm HR 40824 x 15 mm			41122 x 3/4" 41123 x 3/4"* 41126 x 1" 41127 x 1" 41129 x 7/8"	
	41044 x 17 mm○ 41045 x 10 mm○ 41046 x 3/4"○ 41054 x 3/4" 41055 x 1/2"○			41133 x 3/4" 41133 x 22 mm 41133 x 1" 41134 x 1" 41138 x 18 mm	
	41057 x 3/4" 41059 x 3/8" 41061 x 3/8" 41063 x 3/4" 41065 x 3/8"			41138 x 1" 41139 x 18 mm 41139 x 1" 41141 x 1" 41142 x 18 mm	
	41068 x 15 mm 41068 x 3/4"○ 41069 x 3/4"* 41070 x 5/8" 41080 x 3/4"			41142 x 1" 41143 x 3/4"○ 41143 x 1" 41144 x 3/4" 41146 x 3/4"	
	41083 x 3/4" 41084 x 3/4" 41085 x 3/4" 41087 x 3/4"○ 41088 x 3/4"			41148 x 3/4" 45062 x 19 mm 45075 x 20 mm 45076 x 3/4"* 45087 x 34 mm	
	41089 x 3/4" 41090 x 3/4"○ 41091 x 3/4"*● 41092 x 3/4" 41093 x 3/4"●			TP 45097 x 15 mm 45098 x 3/4" 45099 x 3/4" 45117 x 1"* 45118 x 32 mm*	

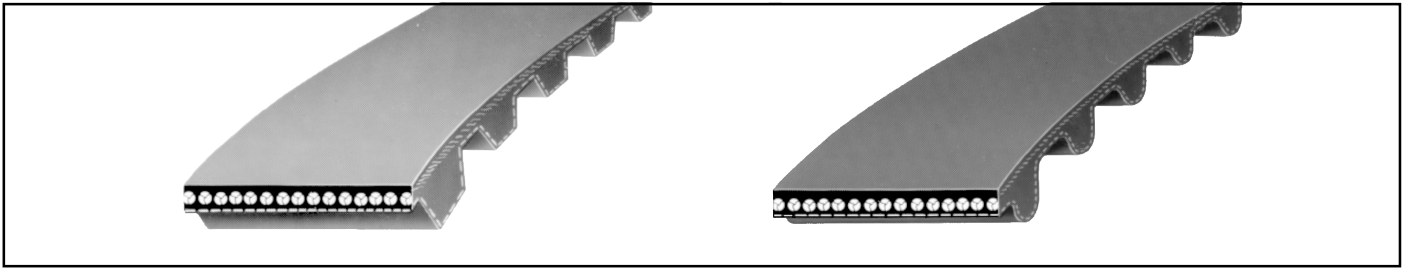

Euro/each	Size	£/each	Euro/each	Size	£/each
	HR 45119 x 25 mm 45119 x 32 mm 45123 x 1" 45130 x 1" 45134 x 30 mm			58151 x 1"* 58153 x 1"* HR 58177 x 1" HR 58219 x 1"* HR 65055 x 1/2"	
	HR 45136 x 1" HR 45143 x 30 mm 45149 x 30 mm 45152 x 30 mm 45153 x 1"*			65083 x 3/4" 65120 x 3/4" 65122 x 3/4" HR 65123 x 3/4" HR 65137 x 23 mm	
	45153 x 30 mm 45163 x 1"○ 45219 x 1"○ 55120 x 9 mm 55122 x 8,6 mm			HR 65137 x 1" 65137 x 30 mm HR 65141 x 25 mm HR 65141 x 30 mm HR 65149 x 30 mm	
	TV 58071 x 17,8 mm 58078 x 19 mm○ HR 58087 x 17 mm HR 58092 x 19,75 mm HR 58094 x 25 mm			65163 x 1" HR 70253 x 1" 70255 x 19 mm HR 70260 x 23 mm HR 70264 x 23 mm	
	HR 58095 x 17 mm* HR 58097 x 19,75 mm HR 58097 x 21,6 mm HR 58101 x 17 mm* HR 58101 x 24 mm*			HR 76070 x 16 mm HR 76089 x 19 mm HR 76089 x 25 mm HR 76091 x 3/4" HR 76092 x 22 mm	
	HR 58104 x 17 mm* 58106 x 19 mm 58106 x 22 mm 58107 x 20 mm HR 58107 x 24 mm			HR 76093 x 25 mm HR 76095 x 3/4" HR 76095 x 25 mm HR 76097 x 25 mm 76102 x 3/4"	
	HR 58108 x 17 mm* 58108 x 24 mm 58109 x 3/4" HR 58109 x 22 mm TP 58110 x 15 mm			HR 76103 x 19 mm*○ HR 76103 x 24 mm HR 76103 x 1" HR 76104 x 24 mm HR 76104 x 1"	
	58110 x 17 mm HR 58110 x 20,7 mm 58111 x 19 mm 58112 x 3/4" HR 58113 x 17 mm*			HR 76106 x 24 mm HR 76107 x 24 mm HR 76108 x 1" HR 76108 x 31,8 mm○ HR 76110 x 1"	
	58113 x 19 mm HR 58114 x 17 mm* HR 58114 x 1" 58115 x 3/4"○ HR 58116 x 3/4"*			HR 76111 x 25 mm HR 76113 x 24 mm HR 76117 x 22 mm HR 76117 x 1"○ HR 76119 x 3/4"	
	58117 x 19 mm HR 58118 x 3/4"* 58121 x 20 mm 58124 x 3/4"* HR 58125 x 19 mm*			HR 76119 x 1" HR 76122 x 19 mm HR 76122 x 24 mm HR 76123 x 3/4" HR 76123 x 29 mm	
	HR 58127 x 3/4"* 58127 x 25 mm○ HR 58129 x 24 mm HR 58129 x 31 mm 58130 x 1"			HR 76124 x 24 mm HR 76124 x 26 mm HR 76124 x 29 mm HR 76127 x 24 mm HR 76127 x 25 mm	
	58133 x 24 mm 58133 x 1"* HR 58134 x 1" HR 58136 x 1" TV 58138 x 28,5 mm			HR 76131 x 25 mm HR 76134 x 1" HR 76139 x 21 mm HR 76143 x 21 mm HR 76148 x 23 mm	
	HR 58141 x 28 mm 58143 x 1"* HR 58144 x 1" HR 58148 x 1"* HR 58149 x 1"			HR 76149 x 1" HR 76151 x 29 mm HR 76152 x 28 mm HR 76153 x 29 mm HR 76157 x 1"	

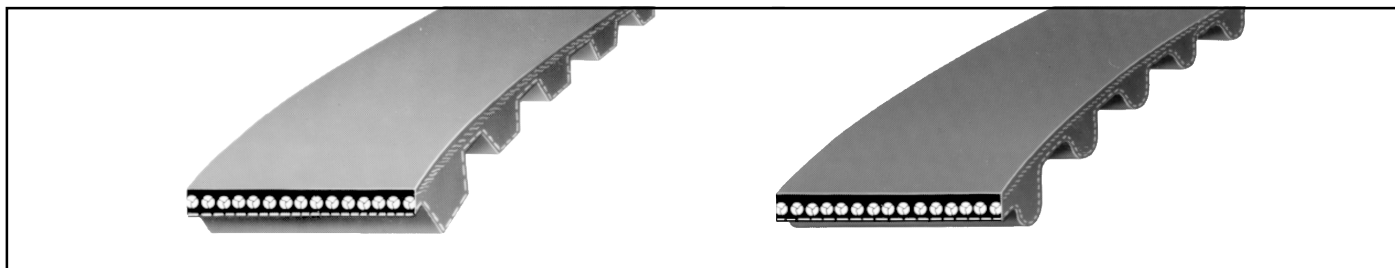

Euro/each	Size	£/each	Euro/each	Size	£/each
	HR 76158 x 32 mm HR 76163 x 25 mm HR 76192 x 28 mm HR 76196 x 28 mm HR 77065 x 1/2"			HR 98116 x 20 mm HR 98130 x 25 mm 98152 x 30 mm 98153 x 30 mm HR 99134 x 18 mm	
	HR 77099 x 3/4 HR 77107 x 18 mm 77107 x 19 mm HR 77107 x 22 mm 77109 x 16 mm			99138 x 15 mm* HR 99158 x 25 mm 99165 x 22 mm HR 99167 x 24 mm 99168 x 18 mm	
	77110 x 3/4" HR 77117 x 29 mm HR 77121 x 29 mm HR 77135 x 25 mm HR 77145 x 22 mm			99168 x 22 mm HR 99168 x 24 mm 99170 x 22 mm 99170 x 25 mm HR 99173 x 18 mm	
	HR 77155 x 3/4" HR 77156 x 29 mm HR 77168 x 1" HR 77211 x 30 mm HR 77257 x 32 mm			99173 x 22 mm 99173 x 25 mm HR 99193 x 24 mm	
	84069 x 3/4" 84119 x 3/4" 84122 x 3/4" 90115 x 25 mm* 90124 x 25 mm		<b>Set requirements</b>		
	90128 x 25 mm HR 90132 x 19 mm 90133 x 19 mm HR 90135 x 19 mm HR 90138 x 23 mm		41091 x 3/4" * ● 41103 x 3/4" * ●		
	90142 x 19 mm 90148 x 1" HR 90150 x 23 mm HR 90151 x 19 mm* HR 90151 x 25 mm		41093 x 3/4" * ● 41105 x 3/4" * ●		
	90152 x 25 mm HR 90162 x 25 mm HR 90162 x 30 mm 90163 x 26,7 mm HR 90164 x 25 mm		41098 x 17 mm ● (2 per set) 41100 x 17 mm ● (2 per set)		
	HR 90173 x 30 mm HR 90239 x 25 mm HR 90253 x 30 mm HR 90299 x 30 mm HR 91098 x 3/4"		<b>Timing Belts – Obsolete / Replacements</b>		
	91119 x 3/4" HR 92137 x 19 mm 92137 x 25 mm HR 92147 x 19 mm HR 92147 x 25 mm		Size old	Size new	
	HR 92192 x 30 mm 9356 x 5/8" HR 96097 x 1" HR 96121 x 18 mm HR 96124 x 18 mm		HR 40279 x 24 mm 40811 x 15 mm HR 45137 x 1" 58134 x 25 mm 77211 x 30 mm	HR 40815 x 24 mm HR 40824 x 15 mm HR 65137 x 1" HR 58134 x 25 mm HR 77211 x 30 mm	
	HR 97077 x 20 mm HR 97080 x 21 mm 97095 x 19 mm HR 97120 x 1" HR 97122 x 1"		90147 x 19 mm HR 90147 x 25 mm HR 90225 x 30 mm HR 91119 x 3/4" HR 97137 x 23 mm	HR 92147 x 19 mm HR 92147 x 25 mm HR 40496 x 30 mm 91119 x 3/4" HR 65137 x 23 mm	
	HR 97122 x 26,5 mm HR 97124 x 1"○ HR 97124 x 26,5 mm 97135 x 25 mm HR 98085 x 23 mm*		HR 97137 x 25 mm 99173 x 18 mm	HR 65137 x 1" HR 99173 x 18 mm	

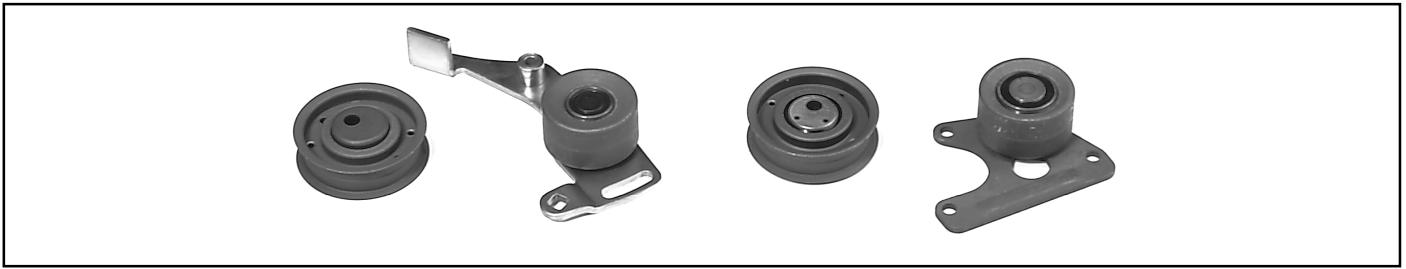

Euro/ each	Designation	£/ each	Application	Euro/ each	Designation	£/ each	Application
	100UT		Audi / VW		300ST		Ford
	101ST		Audi / VW		301ST		Ford
	102ST		Audi / VW		302ST		Ford
	103UT		Audi / VW, Volvo		303ST		Ford
	104UT		Audi / VW		304UT		Ford
	105ST		Audi / VW		305ST		Ford
	106SR		Audi / VW		306ST		Ford
	107UR		Audi / VW		307ST		Ford
	108ST		Audi / VW		308UT		Ford
	110UR		Audi / VW		309UT		Ford
	111UT		Audi / VW		313SR		Ford
	112ST		Audi / VW		315SR		Ford
	113SR		Audi / VW		319UR		Ford
	114SR		Audi / VW				
	116UR		Audi / VW				
	117SR		Audi / VW		350ST		Citroen, Fiat, Lancia
	118SR		Audi / VW				
	119UT		Audi / VW				
	123ST		Audi / VW		357ST		Fiat
					359UT		Fiat
	200ST		BMW		361ST		Fiat
	201ST		BMW		362UT		Fiat
	202UT		BMW		363UT		Fiat, Lancia
	203UT		BMW		364UT		Fiat, Lancia
	204ST		BMW				
	205SR		BMW		400SR		Mercedes Benz
	206SR		BMW		401SR		Mercedes Benz
	206UR		BMW		402SR		Mercedes Benz
	208SR		BMW		403SR		Mercedes Benz
	209SR		BMW		404SR		Mercedes Benz
	210SR		BMW		405SR		Mercedes Benz
	211SR		BMW		406SR		Mercedes Benz
	213UR		BMW		407UR		Mercedes Benz
	214SR		BMW		408UR		Mercedes Benz
	215UR		BMW		409SR		Mercedes Benz
	216SR		BMW		410SR		Mercedes Benz
	217ST		BMW		411SR		Mercedes Benz
	217UT		BMW				
	218SR		BMW				
	219SR		BMW		463UT		Porsche, Seat
	252ST		Citroen				
	254ST		Citroen				
	255UT		Citroen				
	256ST		Citroen				
	262UT		Peugeot				
	268SR		Citroen				
	269SR		Citroen				
	272ST		Citroen				
	274ST		Citroen				
	277UT		Citroen				
	284ST		Citroen				
	285UT		Citroen				
	286ST		Citroen, Renault				
	288UT		Citroen				
	289UT		Citroen				

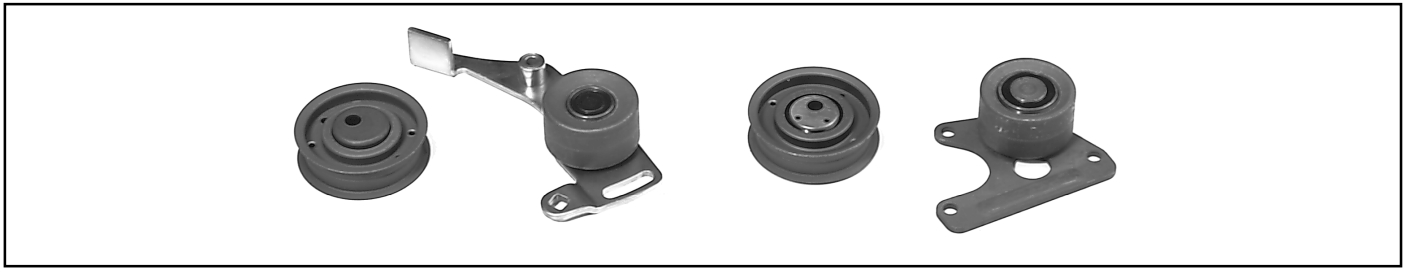

Euro/ each	Designation	£/ each	Application	Euro/ each	Designation	£/ each	Application
	500UT		Opel		700ST		Volvo
	501UT		Opel		701ST		Volvo
	502ST		Opel		703UT		Volvo
	503UT		Opel		704ST		Volvo
	504UT		Opel		705UT		Volvo
	505UT		Opel		707UT		Volvo
	506UT		Opel		708ST		Volvo
	507UT		Opel		709ST		Volvo
	508SR		Opel		710UT		Volvo
	509ST		Opel		714UR		Volvo
	510ST		Opel		715UT		Volvo
	512UT		Opel				
	513ST		Opel		750ST		Saab
	555ST		Citroen, Peugeot		751ST		Lada
	600ST		Renault		809UT		Nissan
	601ST		Renault		810ST		Nissan
	602ST		Renault				
	603UT		Renault				
	604UR		Renault				
	605UR		Renault				
	606ST		Renault				
	607UT		Renault				
	610ST		Renault				
	611UT		Renault				
	614ST		Renault				
	618UT		Renault				
	620ST		Renault, Peugeot				
	621SR		Renault				
	623UT		Renault				
	624SR		Renault				
	625ST		Renault				
	626SR		Renault				

# Measuring Instruments

## Tension Gauges



Optikrik 0	Measuring Range: 70 – 150 N
Optikrik I	Measuring Range: 150 – 600 N
Optikrik II	Measuring Range: 500 – 1400 N
Optikrik III	Measuring Range: 1300 – 3100 N

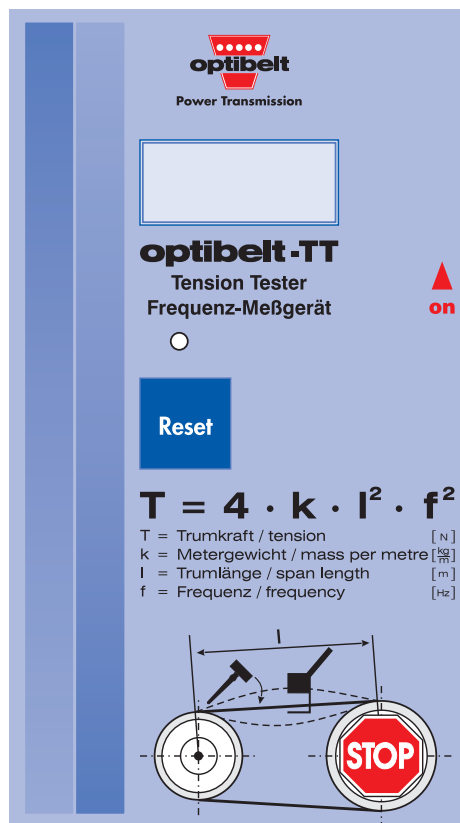

Measuring Range: 10 – 600 Hz

## Measuring Gauge

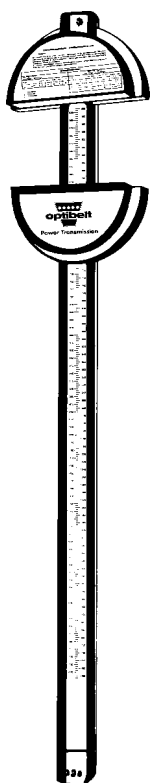

Measuring Range: 500 – 2500 mm inside length (L<sub>i</sub>)

Reprinting in whole or part, forbidden.  
 Infringement will lead to prosecution.  
 Mistakes, or changes due to technical changes excepted.  
 Subject to our "General Conditions of Sale".



## Power Transmission

### Racks for Automotive Belts

Range and prices for automotive belts and literature.

