

Prístrojové kolesá série 222, 222B, 232 s kolesami NOA /nosnosť 55-75 kg/

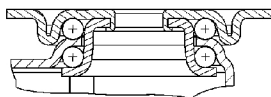
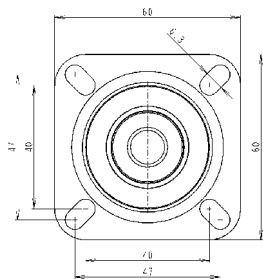

Otočná vidlica lisovaná z oceleového plechu, pozinkovaná, s dvojitým guľičkovým vencom v smerovej otoči, os kolesa zaistená skrutkou

Gehäuse aus Stahlblech, verzinkt-chromatisiert, mit zweireihigem Kugelkranz im Gabelkopf

Housing made of pressed steel zinc-chromatised, double ball bearing swivel head

Upevňovacia príruha štvorhranná-typ P2 na vidlice série 222, 232

Otočná vidlica typ 222



22

Otočné koleso Lenkrolle Swivel castor									
222 NOA-K050	050	22	=	60x60	47/40x47/40	6,3	24	28	55
222 NOA-K075	075	22	=	60x60	47/40x47/40	6,3	24	98	75

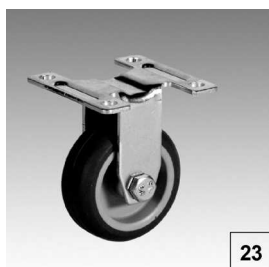

23

Pevné koleso Bockrolle Fixed castor									
232 NOA-K050	050	22	=	60x60	47/40x47/40	6,3	-	28	55
232 NOA-K075	075	22	=	60x60	47/40x47/40	6,3	-	98	75



24

Otočné koleso s brzdou kolesa Rad-feststeller Wheel brake									
222B NOA-K050	050	22	=	60x60	47/40x47/40	6,3	24	28	55
222B NOA-K075	075	22	=	60x60	47/40x47/40	6,3	24	98	75

Samostatné kolesá - séria NOB

/nosnosť 100 kg/









25

Disk kolesa z polypropylénu, behúň - termoplastická gumová obruč /Shore A98/, šedá farba, klzné uloženie /K/

Radkörper aus Polypropylene mit dem Thermoplastische-gummireifen, Gummiqualität: blau grau, /Shore A98/, Gleitlager /K/

Wheel centre of polypropylene, with solid thermoplastic rubber tyre, rubber quality: blue-grey, /Shore A98/, with plain bearing /K/

Samostatné koleso Rad Wheel						
NOB-K080/10	080	30	=	10,1	35	100
NOB-K100/10	100	32	=	10,1	35	100
NOB-K125/10*	125	32	=	10,1	35	100

Kolesá s klzným uložením

* Zahájenie výroby a predaja: február 2005

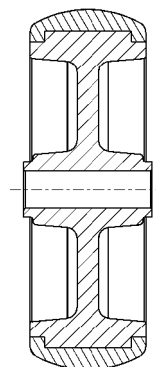

=

Označenie: NOB - K...

Prístrojové kolesá série 353,353F, s kolesami NOB /nosnosť 100 kg/

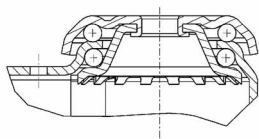
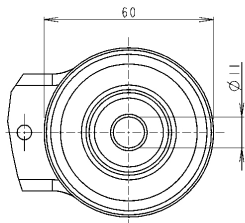

Otočná vidlica lisovaná z oceľového plechu, pozinkovaná, s dvojitým guľíkovým vencom v smerovej otoči, os kolesa zaistená skrutkou

Gehäuse aus Stahlblech, verzinkt-chromatisiert, mit zweireihigem Kugelkranz im Gabelkopf







Housing made of pressed steel zinc-chromatised, double ball bearing swivel head

Upevnenie na stredový otvor Ø11
na otočné vidlice série 353

Otočná vidlica typ 353







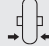

26

Otočné koleso Lenkrolle Swivel castor							 kg
353 NOB-K080	080	30	=	11	38	116	100
353 NOB-K100	100	32	=	11	38	135	100
353 NOB-K125*	125	32	=	11	40	160	100



27

Otočné koleso s total brzdou Total-feststeller Total lock							 kg
353F NOB-K080	080	30	=	11	38	116	100
353F NOB-K100	100	32	=	11	38	135	100
353F NOB-K125*	125	32	=	11	40	160	100



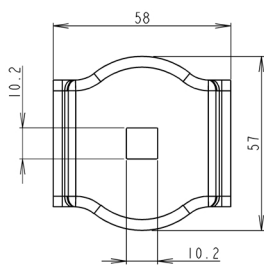



Prístrojové kolesá série 303 s kolesami NOB /nosnosť 100 kg/



Upevnenie na stredový otvor Ø11
na pevné vidlice série 303



28

Pevné koleso Bockrolle Fixed castor						 kg
303 NOB-K080	080	30	=	10,2	116	100
303 NOB-K100	100	32	=	10,2	135	100
303 NOB-K125*	125	32	=	10,2	160	100

* Zahájenie výroby a predaja: február 2005

Prístrojové kolesá série 373,373F s kolesami NOB /nosnosť 100 kg/

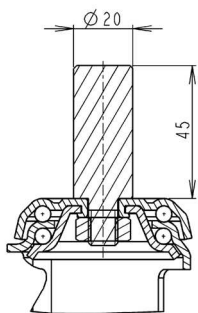

upínanie na hladký čap
Ø 20x45
označenie - 373

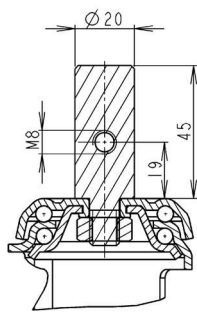

upínanie na hladký čap Ø 20x45
s priečnym otvorom
označenie - 373.....H1









Otočná vidlica lisovaná z oceleového plechu, pozinkovaná, s dvojitým guľíkovým vencom v smerovej otoči, os kolesa zaistená skrutkou

Gehäuse aus Stahlblech, verzinkt-chromatisiert, mit zweireihigem Kugelkranz im Gabelkopf

Housing made of pressed steel zinc-chromatised, double ball bearing swivel head







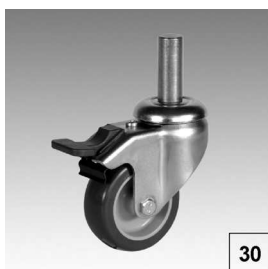



29

Otočné koleso Lenkrolle Swivel castor								
373 NOB-K080	080	30	=	20	45	38	116	100
373 NOB-K100	100	32	=	20	45	38	135	100
373 NOB-K125*	125	32	=	20	45	40	160	100



30

Otočné koleso s total brzdou Total-feststeller Total lock								
373F NOB-K080	080	30	=	20	45	38	116	100
373F NOB-K100	100	32	=	20	45	38	135	100
373F NOB-K125*	125	32	=	20	45	40	160	100

* Zahájenie výroby a predaja: február 2005

Prístrojové kolesá série 323,323F,383 s kolesami NOB /nosnosť 100 kg/

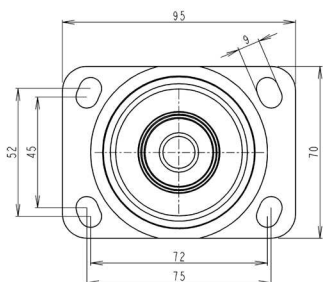

Upevňovacia prírubá štvorhranná-typ P33
na vidlice série 323, 383

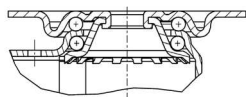

Otočná vidlica typ 323









Otočná vidlica lisovaná z ocelového plechu, pozinkovaná, s dvojším guľičkovým vencom v smerovej otoči, os kolesa zaistená skrutkou

Gehäuse aus Stahlblech, verzinkt-chromatisiert, mit zweireihigem Kugelkranz im Gabelkopf

Housing made of pressed steel zinc-chromatised, double ball bearing swivel head



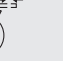







31

Otočné koleso Lenkrolle Swivel castor									
323 NOB-K080	080	30	=	95x70	75/72x52/45	9	38	116	100
323 NOB-K100	100	32	=	95x70	75/72x52/45	9	38	135	100
323 NOB-K125*	125	32	=	95x70	75/72x52/45	9	38	160	100



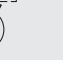



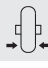

32

Otočné koleso s total brzdou Total-feststeller Total lock									
323F NOB-K080	080	30	=	95x70	75/72x52/45	9	38	116	100
323F NOB-K100	100	32	=	95x70	75/72x52/45	9	38	135	100
323F NOB-K125*	125	32	=	95x70	75/72x52/45	9	38	160	100

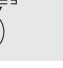

33

Pevné koleso Bockrolle Fixed castor									
383 NOB-K080	080	30	=	95x70	75/72x52/45	9	-	116	100
383 NOB-K100	100	32	=	95x70	75/72x52/45	9	-	135	100
383 NOB-K125*	125	32	=	95x70	75/72x52/45	9	-	160	100

* Zahájenie výroby a predaja: február 2005

Samostatné kolesá - séria NMA

/nosnosť 20-40 kg/









34

Disk kolesa z polypropylénu, behúň - termoplastická gumová obruč /Shore A98/, šedá farba, klzné uloženie /K/

Radkörper aus Polypropylene mit dem Thermoplastische-gummireifen, Gummiqualität: blau grau, /Shore A98/, Gleitlager /K/

Wheel centre of polypropylene, with solid thermoplastic rubber tyre, rubber quality: blue-grey, /Shore A98/, with plain bearing /K/

Samostatné koleso Rad Wheel						 kg
NMA-K027/4	027	14	=	4,1	15,5	20
NMA-K050/6	050	19	=	6,2	21,5	40
NMA-K050/8	050	19	=	8,2	21,5	40

Kolesá s klzným uložením

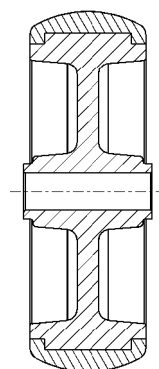

=

Označenie: NMA - K...

Prístrojové kolesá série 241,241B s kolesami NMA /nosnosť 35 kg/

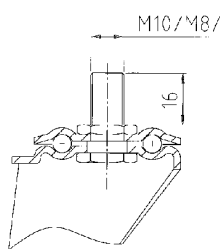

Otočná vidlica lisovaná z ocelového plechu, pozinkovaná, s jednoduchým guľičkovým vencom v smerovej otoči, os kolesa zaistená skrutkou

Gehäuse aus Stahlblech, verzinkt-chromatisiert, mit einreihigem Kugelkranz im Gabelkopf

Housing made of pressed steel zinc-chromatised, single ball bearing swivel head

Upevňovací trň na otočné vidlice série 241



35

Otočné koleso Lenkrolle Swivel castor								
241 NMA-K050 T1	050	19	=	8	15	23	66	35



36

Otočné koleso s brzdou kolesa Rad-feststeller Wheel brake								
241B NMA-K050 T1	050	19	=	8	15	23	66	35

Prístrojové kolesá série 254,254B s kolesami NMA /nosnosť 70 kg/

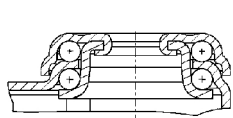
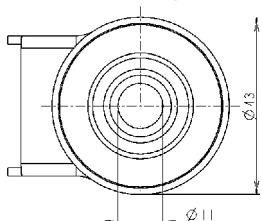

Otočná vidlica lisovaná z ocelového plechu, pozinkovaná, s dvojitým guľičkovým vencom v smerovej otoči, os kolesa zaistená skrutkou

Gehäuse aus Stahlblech, verzinkt-chromatisiert, mit zweireihigem Kugelkranz im Gabelkopf

Housing made of pressed steel zinc-chromatised, double ball bearing swivel head

Upevnenie na stredový otvor Ø11 na otočné vidlice série 254

Otočná vidlica typ 254



37

Otočné koleso Lenkrolle Swivel castor								
254 NMA-K050	050	2x19	=	11	27	66	70	



38

Otočné koleso s brzdou kolesa Rad-feststeller Wheel brake								
254B NMA-K050	050	2x19	=	11	27	66	70	

Prístrojové kolesá série 221,221B,231 s kolesami NMA /nosnosť 20-35kg/

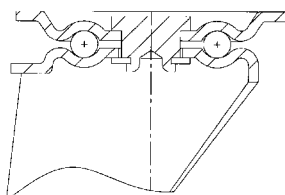
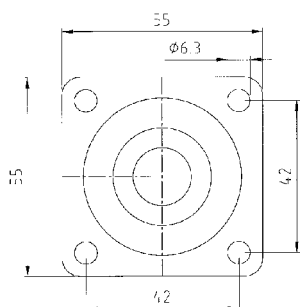

Otočná vidlica z oceleového plechu, pozinkovaná, s jednoduchým guľíkovým vencom v smerovej otoči, os kolesa zaistená skrutkou.

Gehäuse aus Stahlblech, verzinkt-chromatisiert, mit einreihigem Kugelkranz im Gabelkopf

Housing made of pressed steel, zinc-chromatised ball bearing swivel head.

Upevňovacia príruha štvorhranná typ P1 Otočná vidlica typ 221
na vidlice série 221,231



39

Otočné koleso Lenkrolle Swivel castor									
221 NMA-K050	050	19	=	55x55	42x42	6,3	23	66	35



40

Pevné koleso Bockrolle Fixed castor									
231 NMA-K050	050	19	=	55x55	42x42	6,3	-	66	35



41

Pevné koleso Bockrolle Fixed castor									
231 NMA-K027	027	14	=	45x19	35	-	-	29	20



42

Otočné koleso s brzdou kolesa Rad-feststeller Wheel brake									
221B NMA-K050	050	19	=	55x55	42x42	6,3	23	66	35